



Sanitary Gauges

OUTLINE

This pressure gauge has been designed for the field requiring sanitary consideration, and can be extensively applied to foods, medicines, cosmetics and, additionally, biotechnology.

FEATURES

- A stainless steel case or a chromium plated case can be selected according to application and atmospheric condition.
- The case is of waterproof construction. Its easy cleaning is possible and prevention of water drip is easy.
- The liquid contacting portion is made of stainless steel and excellent corrosion resistance is demonstrated.
- A newly-designed diaphragm minimize an error due to temperature.

SPECIFICATION

Fluid:

Gas or liquid

Mounting:

Stem, bottom...Type A, Type A with radiation fin
Stem, back...Type DA, Type DA with radiation fin

Size:

75 DIA., 100 DIA.

Connection type:

Ferrule type, nut type, male type, union type

Size:

1S, 1 1/2S, 2S, 2 1/2S, 3S, G1 1/2B (Union only)

Wetted parts material:

Diaphragm 316Lst.st.
Socket 316st.st. or 316Lst.st.

Pressure range:

0 ~ 0.1 → 0 ~ 3.5MPa (0 ~ 1 → 0 ~ 35kgf/cm²)
-0.1 ~ 0 → -0.1 ~ 2MPa (1 ~ 0 → -1 ~ 20kgf/cm²)

Operating temperature:

Ambient -5 ~ 40°C
Connection -5 ~ 100°C
(With radiation fin -5 ~ 135°C)

Allowable temperature range:

Ambient -5 ~ 60°C
Connection -5 ~ 150°C

Accuracy:

±1.5%F.S.

Temperature coefficient:

Ambient 0.2%F.S./deg or less
Wetted parts 0.1%F.S./deg or less

Filled liquid:

Propylene glycol
(Silicon oil for vacuum and compound range)

Case material:

YBsC3 chrome plating or 304st.st.

Construction:

Water-proof type

DIMENSIONS

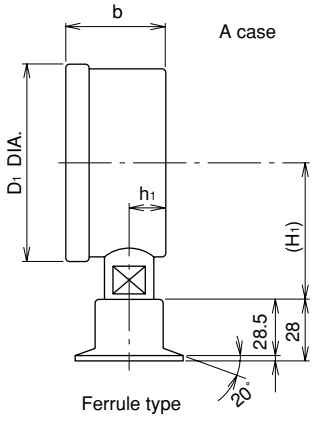

Case	D ₁	b	H ₁	h ₁	H ₂	h ₂
Chrome plating	75	94	47.6	64	19	70.6
Stainless steel	100	119	48.5	76.5	18	71.5
Stainless steel	75	83	43.5	64	17.5	67.5
Stainless steel	100	107	48.5	76.5	19	71.5

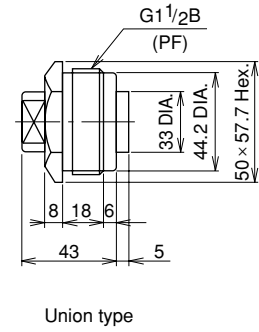
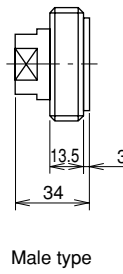
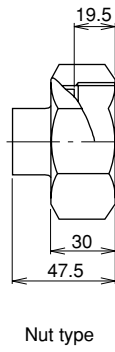
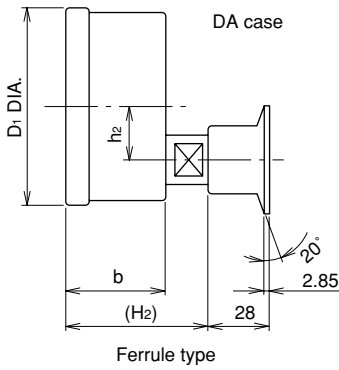
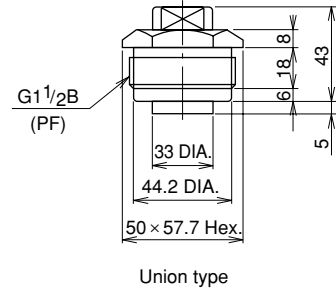
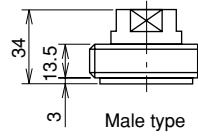
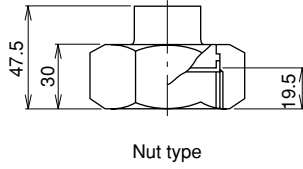

With radiation fin

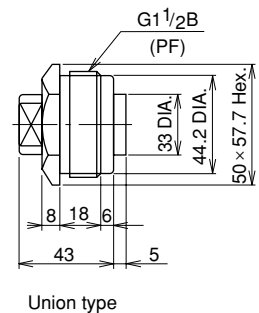
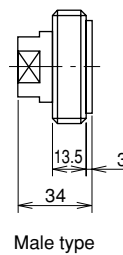
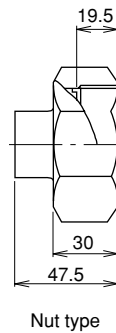
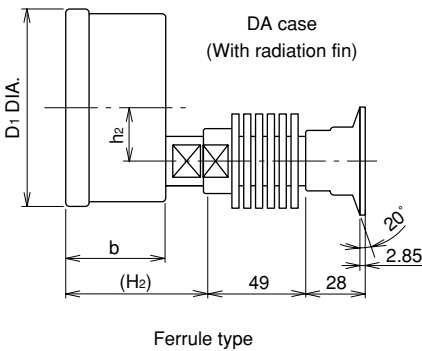
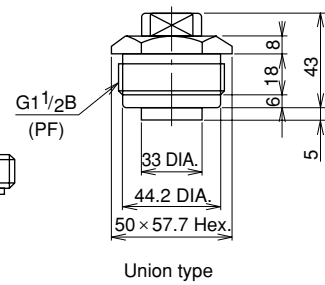
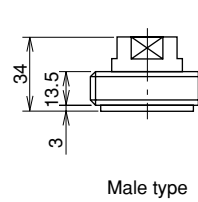
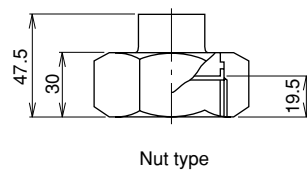
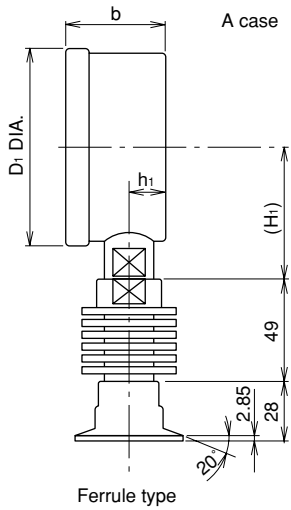

Type No. constitution

Please specify Type No., each specification and range, when ordering.

Note: For this Model, there is no applicable item for the figures X, but please specify X when ordering.

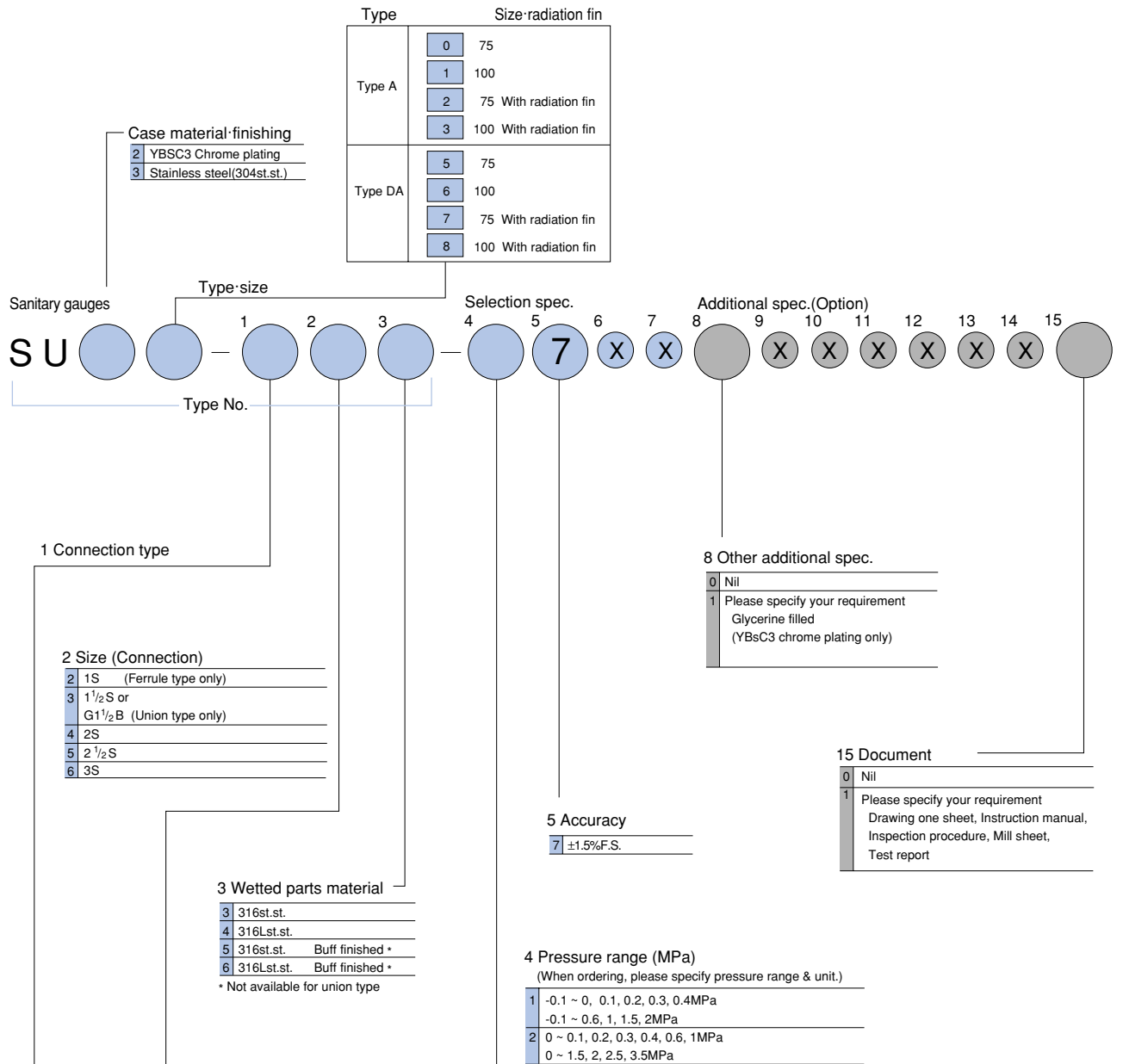

Manufacturing range

Connection type	Size	0~0.1	-0.1~0	0~0.4	0~1.5	-0.1~0.3	-0.1~1	0~2.5
		0~0.2	-0.1~0.1	0~0.6	0~2.0	-0.1~0.4	-0.1~1.5	0~3.5
1 Ferrule type	1S, 1 1/2 S		○			○		○
	2S	○				○		○
2 Nut type	1 1/2 S		○			○		○
	2S	○				○		○
3 Male type	1 1/2 S		○			○		○
	2S	○				○		○
4 Union type	1 1/2 S		○			○		○
	2 1/2 S, 3S	○				○		○
	G1 1/2 B					○		○

* Clamp, nut, gasket, etc., which is necessary for installation should be provided by customer.