



# Model SU15 Sanitary Pressure Transmitter

## OUTLINE

This is a transmitter with sanitary specifications in which a stainless steel diaphragm and a semiconductor strain gauge have been installed. Special attention in design and manufacture regarding sanitary application has been paid. Accordingly, this sanitary pressure transmitter can be extensively applied to the manufacture of foods, medicines, cosmetics and, further, biotechnological product.

## FEATURES

- This sanitary pressure transmitter is equipped with excellent enduring properties against pressure pulsation, vibration and impact, because of semiconductor strain gauge application.
- Unified signal output is provided because of a built-in amplifier.
- Excellent corrosion properties are provided because a metallic diaphragm is installed.
- Easy draining-water-off properties are provided, making people feel clean, because a stainless steel case is applied.

## SPECIFICATION

### Fluid:

Gas or liquid

### Operating condition:

Under the normal condition, where there is no inflammable gas or liquid which cause the ignition or explosion.

### Connection type:

Ferrule type, nut type, male type, union type, homogenizer type

### Cable:

With 2 m shielded cable

### Size (Connection):

Homogenizer type, 1S, 1 1/2S, 2S, 2 1/2S, 3S, G1 1/2B

### Wetted parts material:

Diaphragm 316L st.st.  
Socket 316 st.st. or 316L st.st.

### Pressure range:

0 ~ 0.3 → 0 ~ 50MPa (0 ~ 3 → 0 ~ 500kgf/cm<sup>2</sup>)  
-0.1 ~ 0.2 → -0.1 ~ 2MPa (-1 ~ 2 → -1 ~ 20kgf/cm<sup>2</sup>)

### Pressure-proof sensing part:

2 ~ 100MPa (Depending on range)

### Max. allowable pressure:

Proof - pressure of sensing parts or the 2 times of pressure range, whichever pressure is smaller. (But 35 and 50MPa ranges are 150 %)

### Operating temperature:

-5 ~ 70 °C (Ambient and connecting parts)

### Power source:

24V DC ±10%

### Output:

4 ~ 20mA DC (2 wire system)  
1 ~ 5V DC (3 wire system)

### Load resistance:

500Ω max. (Current output)  
10kΩ min. (Voltage output)

### Transmission system:

2 or 3 wire system

### Accuracy:

±1.0% F.S.  
(But 0.3MPa range or less, 50MPa range is ± 1.5 % F.S.)

### Temperature coefficient:

±0.1% F.S./°C (Zero)  
±0.1% F.S./°C (Span)  
(But 0.3MPa range or less, 50MPa range is ± 1.5 % F.S./°C)

### Filled liquid:

Propylene glycol (But enclosed liquid of compound pressure gauge is silicon oil.)

### Case material:

316 st.st.

### Construction:

Drip-proof II

## DIMENSIONS

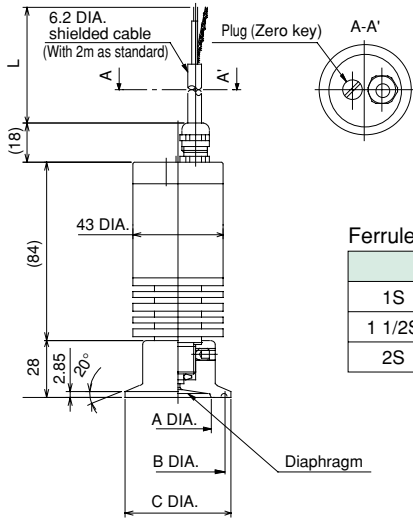

Ferrule type

Ferrule type

	A	B	C
1S	32	43.5	50.5
1 1/2S	32	43.5	50.5
2S	47	56.5	64

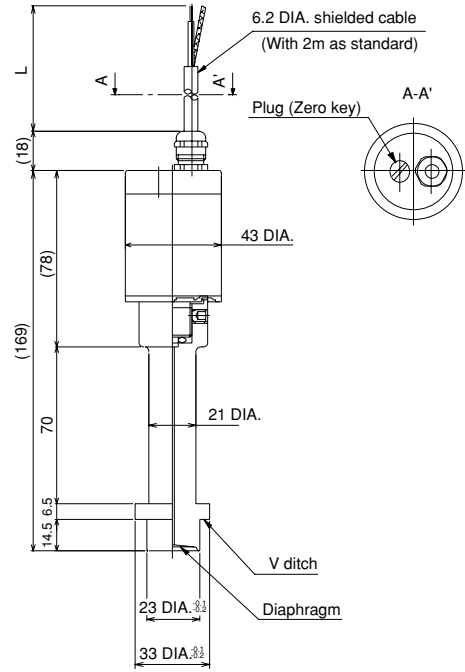

Homogenizer type

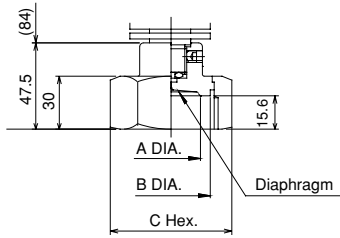

Nut type

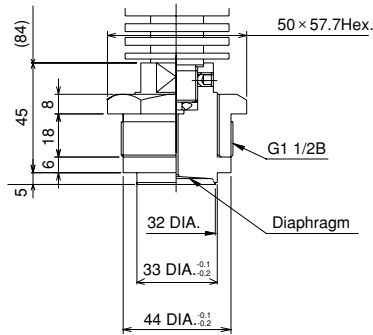

Union type

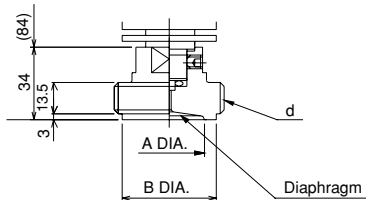

Male type

Nut type, Male type

	A	B	C (Nut type only)
1 1/2S	32	42.7	56 x 64.7Hex.
2S	47	56.2	71 x 82Hex.

## WIRING

2 wire system

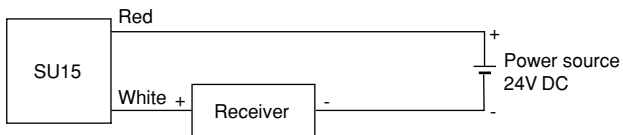

3 wire system

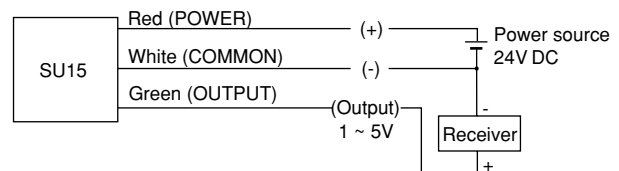

# Type No. constitution

Please specify Type No., each specification and range when ordering.

Note: For this Model, there is no applicable item for the figures X, but please specify X when ordering.

Sanitary pressure transmitter

S U 1 5

Type No.

Selection spec.

Additional spec. (option)

1 Connection type

1	Ferrule type
2	Nut type
3	Male type
4	Union type
5	Homogenizer type

2 Size (Connection)

0	Homogenizer type
2	1S
3	1 1/2S or G1 1/2B
4	2S
5	2 1/2S
6	3S

3 Wetted parts material

3	316 st.st.
4	316L st.st.
5	316 st.st. Buff finished
6	316L st.st. Buff finished

7 Output

1	4 ~ 20mA DC (2 wire system)
8	1 ~ 5V DC (3 wire system)

6 Power source

1	24V DC ±10%
---	-------------

5 Accuracy

0	±1.0%F.S. (0.3MPa range or less, 50MPa range is ±1.5 % F.S)
---	--

15 Document

0	Nil
1	Please specify your requirement Drawing one sheet, Instruction manual, Inspection procedure, Mill sheet, Test report

4 Pressure range (MPa)

(When ordering, please specify pressure range & unit.)

Connection type	Size	Pressure range (MPa)					Pressure-proof sensing part MPa
		1 -0.1 ~ 0.2 ~ 0.3 ~ 0.5	2 0 ~ 0.1 0 ~ 1 ~ 2	3 0 ~ 0.3 0 ~ 0.5 ~ 1	4 0 ~ 3.5	5 0 ~ 5 0 ~ 10 ~ 20 ~ 35	
1 Ferrule type	1S	○	○	○	-	-	3.5
	1 1/2S	○	○	○	-	-	
	2S	○	○	○	-	-	
	2 1/2S	○	○	-	-	-	2
	3S	○	○	-	-	-	
2 Nut type	1 1/2S	○	○	○	○	-	10
	2S	○	○	○	○	-	7
	2 1/2S	○	○	-	-	-	5
	3S	○	○	-	-	-	
3 Male type	1 1/2S	○	○	○	○	-	10
	2S	○	○	○	○	-	7
	2 1/2S	○	○	-	-	-	5
	3S	○	○	-	-	-	
4 Union type	G1 1/2B	○	○	○	○	-	10
5 Homogenizer type	Homogenizer type	-	-	-	-	○	100

\* Please provide the clamp, nut or gasket, etc., which is necessary for installing this transmitter.