



# GC67 DIGITAL PRESSURE GAUGE

## OUTLINE

Catering to needs for "downsizing," "integration," and "space-saving" that are required of factory automation facilities in various industries.

Equipped with a stainless-steel diaphragm sensor to measure wide-ranging fluid pressure.

The digital pressure gauge is equipped with comparator output terminals.

## FUTURE

- The stainless-steel diaphragm sensor, which excels in pressure resistance, corrosion resistance, and durability, and a joints are made integral in a weld-structure to improve reliability.
- The compact pressure gauge is equipped with an LED for display of 10-mm letters.
- The pressure switch has been improved for quicker response, and two high-speed comparator output terminals are provided.
- An analog output terminal for a monitor is available as an option.

## SPECIFICATION

### Pressure range (Max. display digit):

- 100 ~ 100kPa (100)
- 0 ~ 1MPa (1.000)
- 0.1 ~ 1MPa (1.000)

### Application fluid:

Air, water, oil (Non corrosive gas or liquid)

### Wetted parts material:

630st.st. (17-4PH), 304st.st.

### Case material:

Front desk case part: PC/ABS  
Rear case part: ADC12

### Allowable max. pressure:

200% of pressure range

### Accuracy:

Display accuracy:  $\pm (1.0\%F.S.+1\text{digit})$   
Temperature characteristic:  $\pm 0.1\%F.S./^{\circ}\text{C}$

### Display:

Display type: 3-1/2 digit LEDdisplay (Height of letter: 10mm)  
Display period: 0.2s

### Power source/consumption electric current:

12 ~ 24V DC  $\pm 10\%$ /30mA DC or less

### Comparator output:

Open collector: NPN type 2 output (30V DC, 80mA max.)  
Hysteresis-Window comparator mode  
Response time: 2.5ms (A case without a filter)  
Protective circuit: Short circuit (excess current)protection

### Analog output (Option):

Voltage output: 1 ~ 5V DC Load resistance 10k $\Omega$  or less  
Output accuracy:  $\pm 3\%F.S.$   
Response time: 1ms or less

### Cable:

Length: 2m

### Operating temperature:

-10 ~ 50 $^{\circ}\text{C}$

### Operating humidity range:

35 ~ 85%RH (But should not be frozen)

### Construction:

Indoor application only (IP40)

### Process connection:

R1/8-M5

### Weight:

Approx.100g (Contain cable 2 m)

## DIMENSIONS

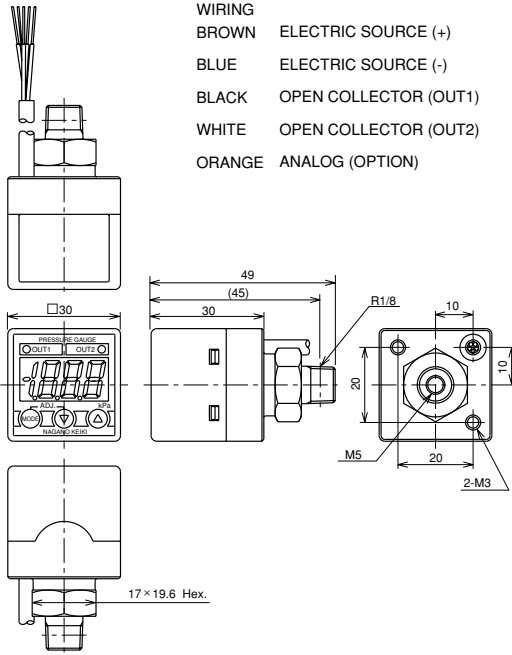

## ATTACHMENT

Option

A figure of panel adapter mounting

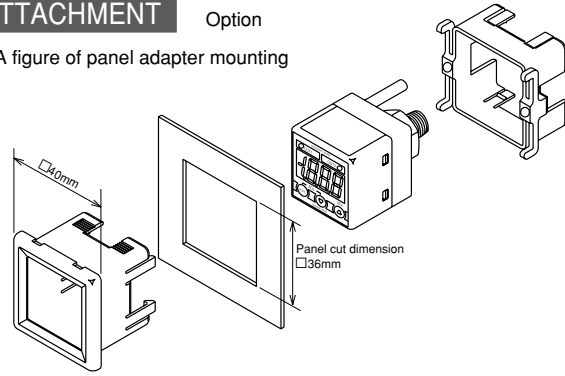

## L TYPE CLUMP

Accessory

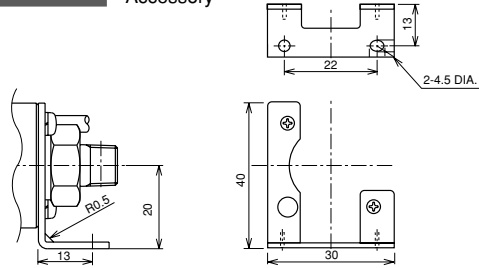

## Type No. constitution

Please specify Type No., each specification and range, when ordering.

Note: For this Model, there is no applicable item for the figures X, but please specify X when ordering.

Selection spec. Additional spec. (Option)

Digital pressure gauge 1 2 3 4 5 6 7 8 9 10 11 12 13 14 15

**GC67-364-6N0-9-0-8-0-0-0-0-0-0-0-0-0-0**

Type No.

1 Mounting  
 3 Horizontal mounting

2 Connection  
 6 R1/8 (With M5 female)  
 \* If other connections are required, please contact us.

3 Wetted parts material  
 4 Welding type  
 (630st.st.(17-4PH)+304st.st.)

4 Pressure range  
 (Display figures)  
 1 -100 ~ 100kPa (100)  
 2 0 ~ 1MPa (1,000)  
 3 - 0.1 ~ 1MPa (1,000)  
 \* It is on besides the above range, and ask it.

5 Display accuracy  
 6 ±1.0%F.S.

6 Power source  
 N 12 ~ 24V DC

7 Comparator output  
 0 NPN Open collector × 2 output  
 (30V DC, 80mA max.)

8 Analog output  
 0 Nil  
 8 1 ~ 5V DC

9 Attachment  
 0 Nil  
 1 Panel adapter

15 Document  
 0 Nil  
 1 Please specify your requirement  
 Drawing one sheet, Instruction  
 manual, Inspection procedure,  
 Test report

Specify the pressure range of the sensor without fail.

The contents in the catalogue are subject to change without notice.

**NAGANO KEIKI CO., LTD.**



UEDA FACTORY (JQA-0794)  
 MARUKO FACTORY (JQA-0789)

HEAD OFFICE & OVERSEAS : 1-30-4, HIGASHIMAGOME OHTA-KU, TOKYO, JAPAN.  
 TELEPHONE : 03 (3776) 5328  
 SALES DEPT FAX : 03 (3776) 5447  
 TELEX : 2468452 NKSTKY J

OVERSEAS PLANTS  
 OR AFFILIATES: U.S.A., KOREA, GERMANY  
 OVERSEAS SALES NETWORK: AUSTRALIA, HONG KONG, INDONESIA,  
 KOREA, MALAYSIA, PHILIPPINES,  
 SINGAPORE, TAIWAN, THAILAND, U.S.A.